

# CASHMERE SLIM 750 OPEN WALL VANITY

## PRODUCT SPECIFICATIONS



### CABINET

<b>INSTALLATION</b>	Wall Hung
<b>CONFIGURATION</b>	Open Shelf
<b>MATERIAL</b>	Moisture Resistant Board
<b>WIDTH (mm)</b>	740
<b>DEPTH (mm)</b>	380
<b>HEIGHT (mm)</b>	430
<b>ORIGIN</b>	Aotearoa / New Zealand

### VANITY TOP

<b>FINISH</b>	Gloss White
<b>MATERIAL</b>	Composite
<b>TAP HOLE</b>	Yes
<b>OVERFLOW</b>	Yes
<b>WASTE SIZE</b>	Suits 32mm and 40mm waste traps
<b>WASTE INCLUDED</b>	No
<b>WIDTH (mm)</b>	750
<b>DEPTH (mm)</b>	397
<b>ORIGIN</b>	PRC
<b>STANDARD APPROVAL</b>	AS/NZS 1730:1996

### PRODUCT CODES & FINISHES



4CSL075WO01

White Melamine



4CSL075WO02

Ultra Gloss White -  
Front Panels Only



4CSL075WO23

Baroque



4CSL075WO25

Premium Oak



4CSL075WO30

Hickory Walnut



4CSL075WO31

Blackened Elm



4CSL075WO32

Rural Oak



4CSL075WO82

Nordic Ash



4CSL075WO93

Charred Oak



4CSL075WO95

Dark Oak

### NOTES

- 5 year warranty \*
- Cabinets made from moisture resistant board with PUR bonding technology are sustainably sourced from FSC certified NZ Radiata Pine.
- Optional - Pop-Up Waste. \*\*

ALL MEASUREMENTS ARE NOMINAL.

\*WARRANTIES APPLY TO RESIDENTIAL DOMESTIC USE ONLY. WARRANTY VOID IF PRODUCT IS NOT INSTALLED ACCORDING TO OUR SPECIFICATIONS.

\*\*FOR FURTHER INFORMATION ON INSTALLATION GUIDE AND PRODUCT OPTIONS PLEASE REFER TO THE WEBSITE.

CLEARLITE.CO.NZ

# CASHMERE SLIM 750 OPEN WALL VANITY

## TECHNICAL SPECIFICATIONS

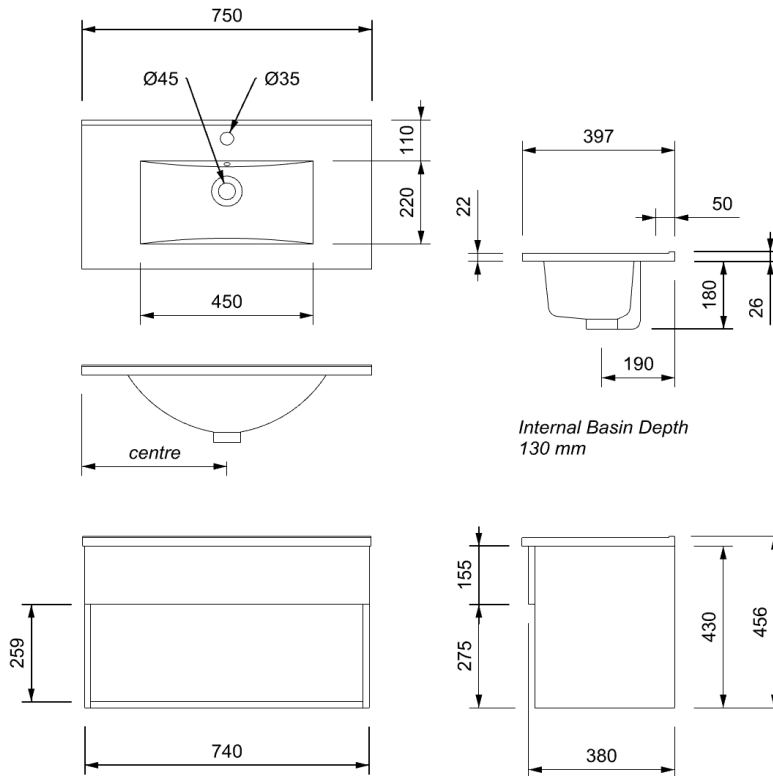

ALL MEASUREMENTS ARE NOMINAL.

\*WARRANTIES APPLY TO RESIDENTIAL DOMESTIC USE ONLY. WARRANTY VOID IF PRODUCT IS NOT INSTALLED ACCORDING TO OUR SPECIFICATIONS

\*\*FOR FURTHER INFORMATION ON INSTALLATION GUIDE AND PRODUCT OPTIONS PLEASE REFER TO THE WEBSITE.

[CLEARLITE.CO.NZ](http://CLEARLITE.CO.NZ)