

SPECIFICATION SHEET

Avila 750mm 1 Drawer Wall Vanity



Features

- Wall Hung
- Soft close full extension drawer
- Negative detail finger pull
- Water resistant materials
- Single Basin
- Colours: Timber Veneer on Plywood
- Dimensions: H415 x W750 x D465

Colour Options with Code



Blanco Oak
8680BO



Washed Oak
8680WO



American Walnut
8680AW



Dark Oak
8680DO

Technical Details

Note: All measurements shown are in millimetres. Sizes are nominal.

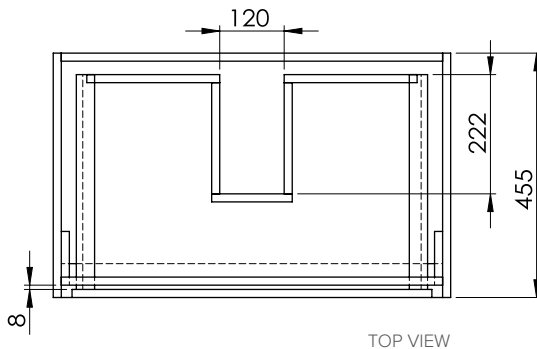

TOP VIEW

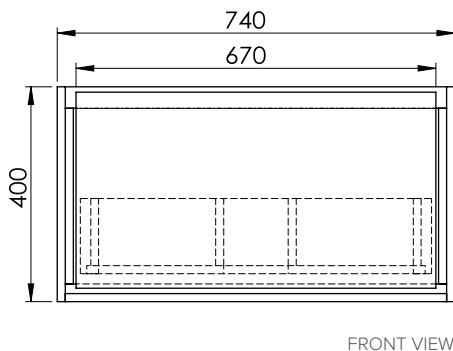
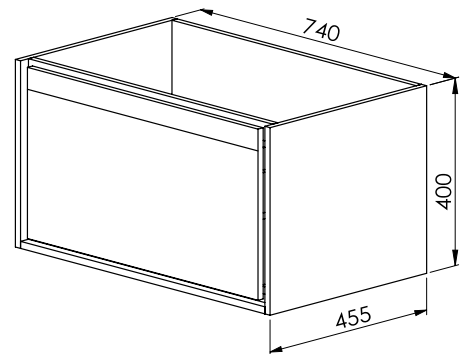

FRONT VIEW

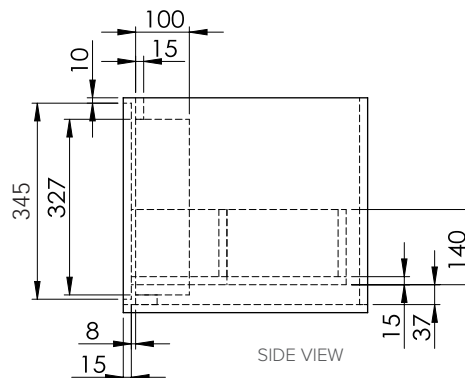

SIDE VIEW